

Installation Instructions

Surface Fixed

Harmony Bell
Page 1 of 2



Instrument
Components:

Metric Conversion:
1650mm/ 64 61/64"
1500mm/ 59 1/16"
1350mm/ 53 5/32"
1.5m/ 59"

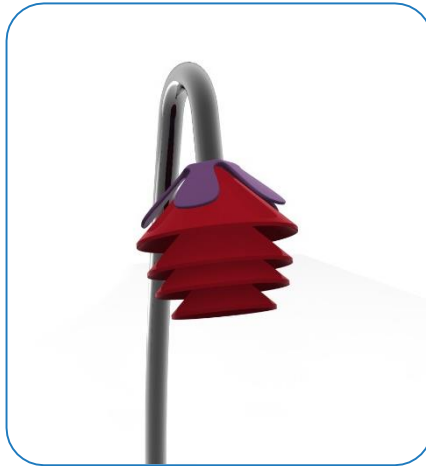

Weight of heaviest part **8kg** (Large Bell)

1. Unpack ground fixing leg
1no.

2. Lay packaging out on floor
or assemble on non-abrasive
surface to prevent marking of
polished stainless steel.

3. Align holes on leg to holes
on surface fixing plate
(opposite end to polished
domes) and secure in place
using 1no. M10x 40mm
Screw and Barrel Nut
provided. Tools required TX
45 Driver Bits)

4. Invert assembled frame so
Bells are at the top.

5. **Locate Bells** in desired
location and mark holes to fix
to surface.

6. Fix to Surface using
recommended ground
anchors (**Ground Anchors
are not supplied**)

7. Make sure all fixings are
covered and secure using
cover caps provided

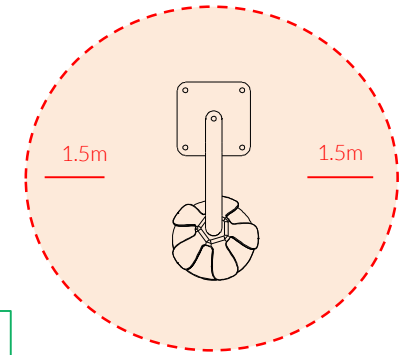

Install
Instrument
with 1.5m free
space (from
widest point)
around it.

Large 1650mm
Medium 1500mm
Small 1350mm
from plate

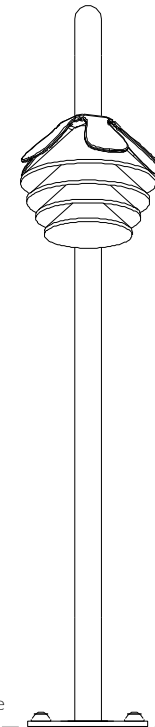

Ground Surface



Small
Beaters X1

Surface Fix
Components:

 x1

 x1

 x4

**Ground Anchors
not supplied**

Spares available from
percussionplay.com or from your
local distributor

14 Kg

Tools:



x1
TX 45 Driver Bit

Surface Fixed

Harmony Bell
Page 2 of 2



Instrument
Components:

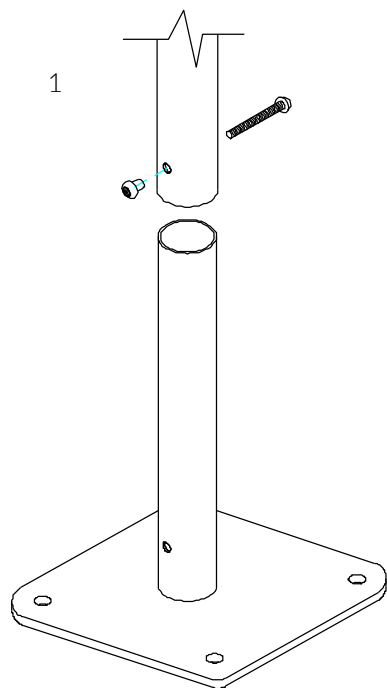

Locate the Surface fix Plate into the leg of the instrument.

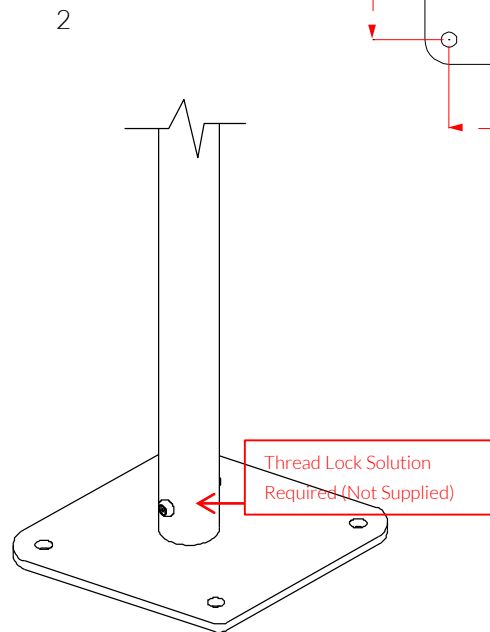

Fix instrument to Surface fix plate using M10 bolt and Barrel Nut and use **thread locking solution** to prevent fixings working loose.

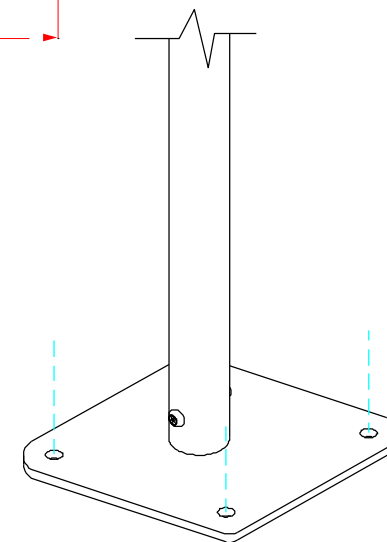
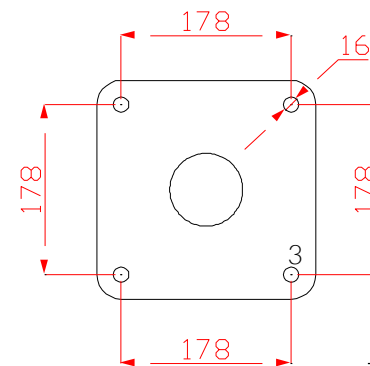

Fix Surface Plate to the ground surface **Ground Anchors Not provided** cover fixings with caps provided

Thread Lock Solution Required



Small Beaters X1

Surface Fix Components:



x1



x1



x4

Ground Anchors not supplied

Spares available from percussionplay.com or from your local distributor

30 Kg