

Installation Instructions



1. Attach the steel legs to the resonators assembly of the instrument with the M8x60 security screws and lock washers. (See Assembly Guide)

2. Attach Surface Fixing Plates to base of Resonator Assembly (See Surface Fix Post Installation Sheet)

3. Attach the Resonator assembly to the underside to the note assembly by locating plate into pre cut recess using CSK Screws and Barrel Nuts provided (See Assembly Guide)

4. Locate Instrument in desired location and mark holes to fix to desired surface.

5. Fix to Surface using recommended ground anchors not supplied

6. Make sure all fixings are covered and secure using cover caps provided

7. Attach the 1 pair of beater to the saddle strap on the leg. (1.3)

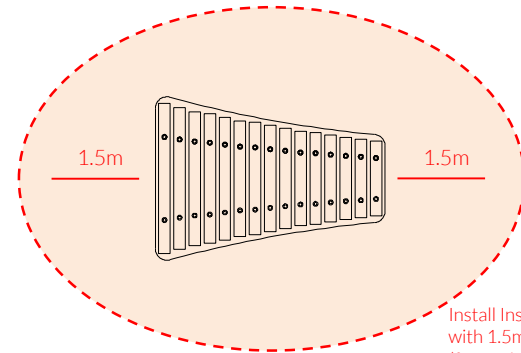

Install Instrument with 1.5m free space (from widest point) around it.

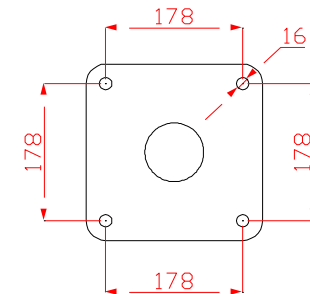
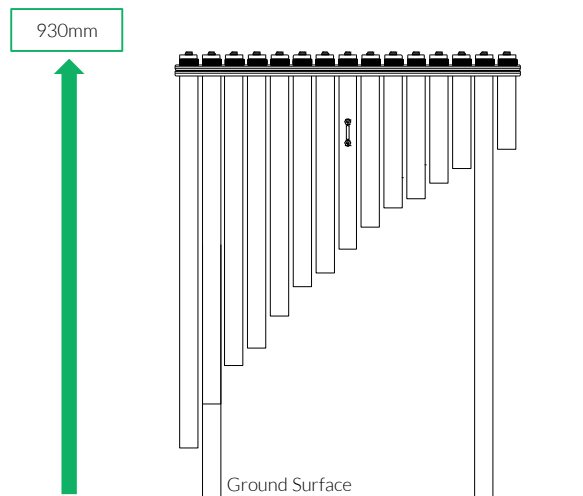

(1.3)

Metric Conversion:
250mm/ 10"
300mm/ 12"
450mm/ 18"
930mm/ 36"
1.5m/ 59"

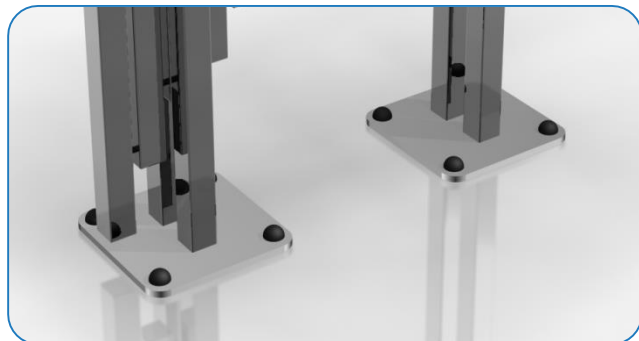

Weight of heaviest part 15kg (Resonators)

Surface Fixed

Capella
Page 1 of 3



Instrument Components:



x8

M8x30 CSK Security Screw



x8

M8x60 Security Screw



x4

M6x20 Security Screw



x2

M6 Saddle Strap



x8

M8 Barrel Nut



Pair Small Red Beaters X2

Surface Fix Components:



x4

M10x30 Security Screw



x8

2 Part Cover Cap

Ground Anchors not supplied

30 Kg

Assembly Guide PPCAPELLA



Tools:

x1 TX 30 Driver Bit

x1 TX 40 Driver Bit

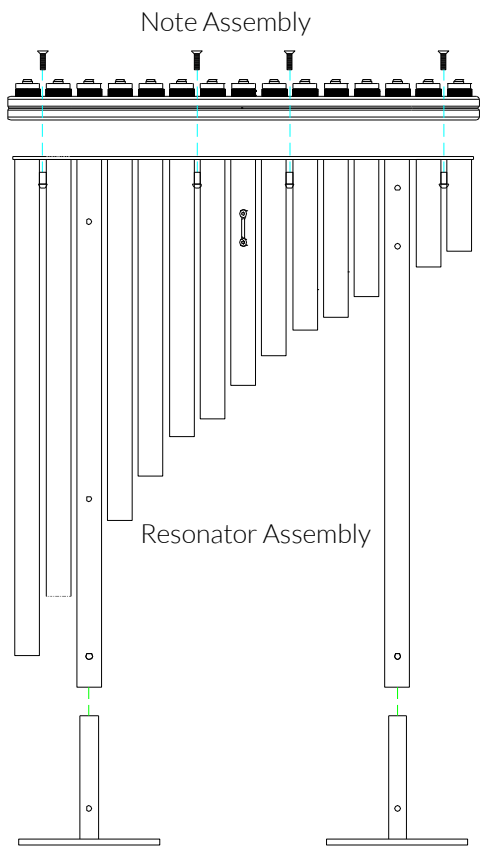

Thread Lock Solution Required (Not Supplied)

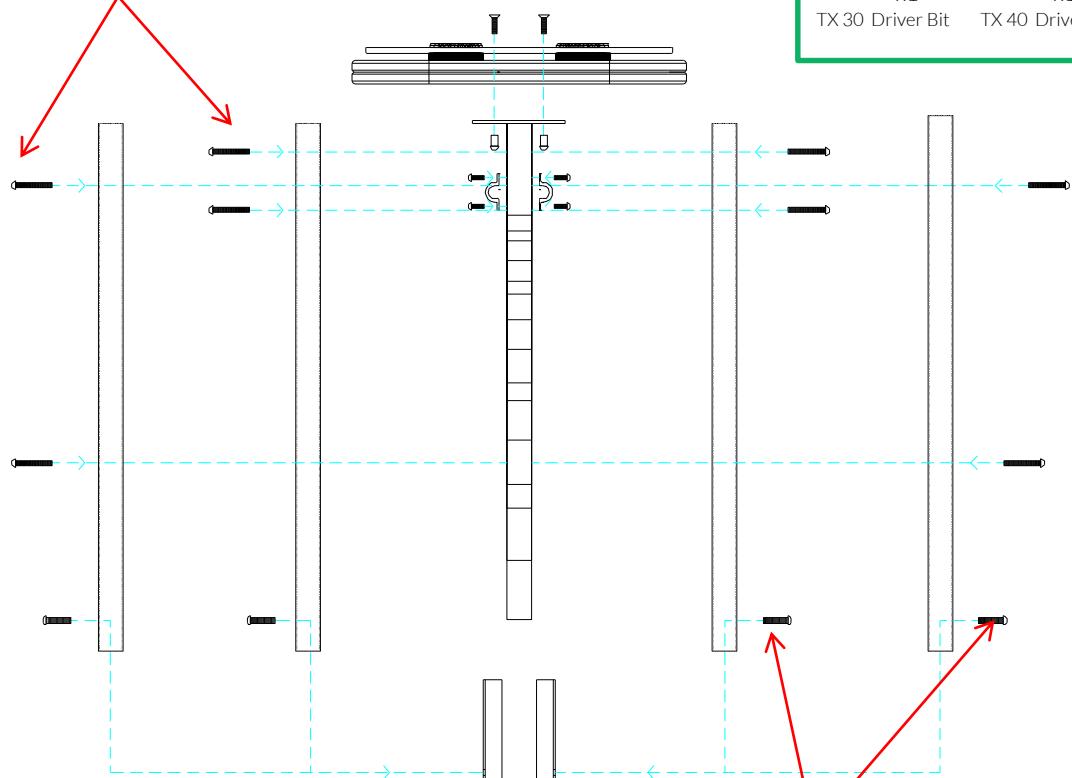

- COMPONENTS LIST:**
- M8x60 Pin torx X8
 - M8 Barrel Nut Pin torx X8
 - M8x30 CSK Pin torx X8
 - Saddle Strap X2
 - M6x20 Pin torx X4
 - M10x30 Pin torx X4

Thread Lock Solution Required (Not Supplied)

Surface Fixed
Capella
Page 2 of 3



Instrument Components:

- x8
M8x30 CSK Security Screw
- x8
M8x60 Security Screw
- x4
M6x20 Security Screw
- x2
M6 Saddle Strap
- x8
M8 Barrel Nut

Thread Lock Solution Required (Not Supplied)

Pair Small Red Beaters X2

Surface Fix Components:

x4
M10x30 Security Screw

x8
2 Part Cover Cap

Ground Anchors not supplied

30 Kg



Surface Fix Post Installation

Tools:

x1
TX 45 Driver Bit

Surface Fixed

Capella
Page 3 of 3



Components:



x4

M10x30 Security Screw



x8

2 Part Cover Cap

Thread Lock Solution
Required (Not Supplied)

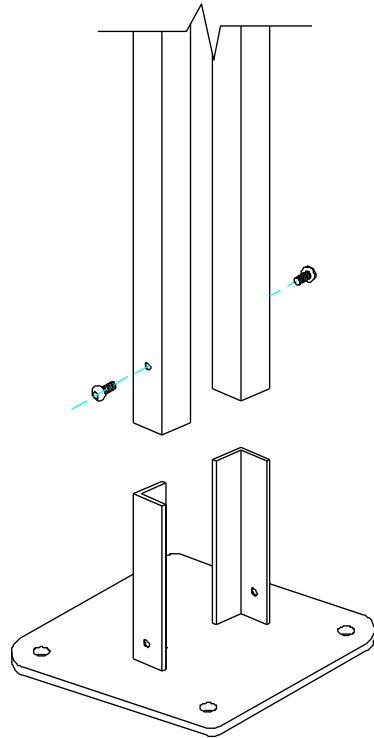

Insert Surface Plates into
bottom of square legs

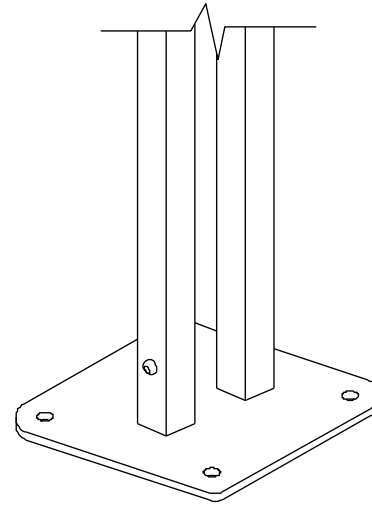

Fix instrument to Surface
fix plates using M10 x
30mm Screws using
thread locking solution
to prevent fixings working
loose.

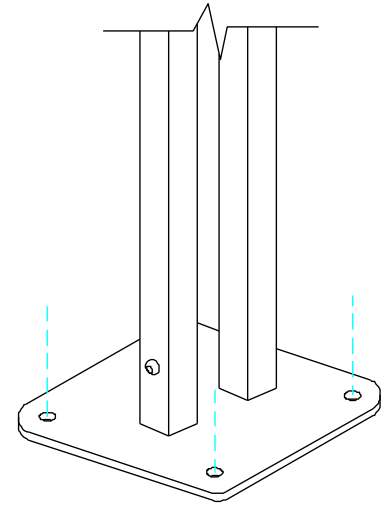

Fix Surface Plates to the
ground surface **Ground
Anchors Not provided**
cover fixings with caps
provided



MADE IN
BRITAIN

BSEN 1176